

CAMPKIN ROAD

HAWKINS ROAD

THE GROVE
PRIMARY SCHOOL

SCHEDULE

- Affordable Units
 - 3No 2B4P Houses (75sqm)
 - 2No 3B5P Houses (89sqm)
- 2No 1B2P Flats (56sqm)
- 2No 1B2P Flats (50sqm)

TOTAL UNITS 9No

- Notes**
- All dimensions to be verified on site by GENERAL CONTRACTOR and any discrepancies to be brought to the attention of the Architect prior to commencing work or setting out or preparing shop drawings.
 - Drawings not to be scaled. Work to figured dimensions only.
 - © copyright SAUNDERS BOSTON LIMITED. All rights reserved. This drawing remains the property of SAUNDERS BOSTON LIMITED at all times and may not be reproduced or copied in whole or in part without their prior written consent.
 - This drawing and related specifications are for use only in the stated location.
 - This drawing is to be read in conjunction with all other Consultants drawings and specifications.
 - Drainage has not been surveyed and all pipe locations and below ground drainage runs are indicative.

KEY

- Site Boundary
- Allocated parking spaces
- Private Greenspace
- Public Greenspace
- Trees to be retained
- Trees to be removed
- Proposed Trees
- Proposed planting
- New rotary dryer
- Block Paving (Type A)
- Block Paving (Type B)
- Raised Surface
- 600 x 600 Concrete paving slabs (pedestrian paths in back gardens from patio to sheds)
- Grass Crete

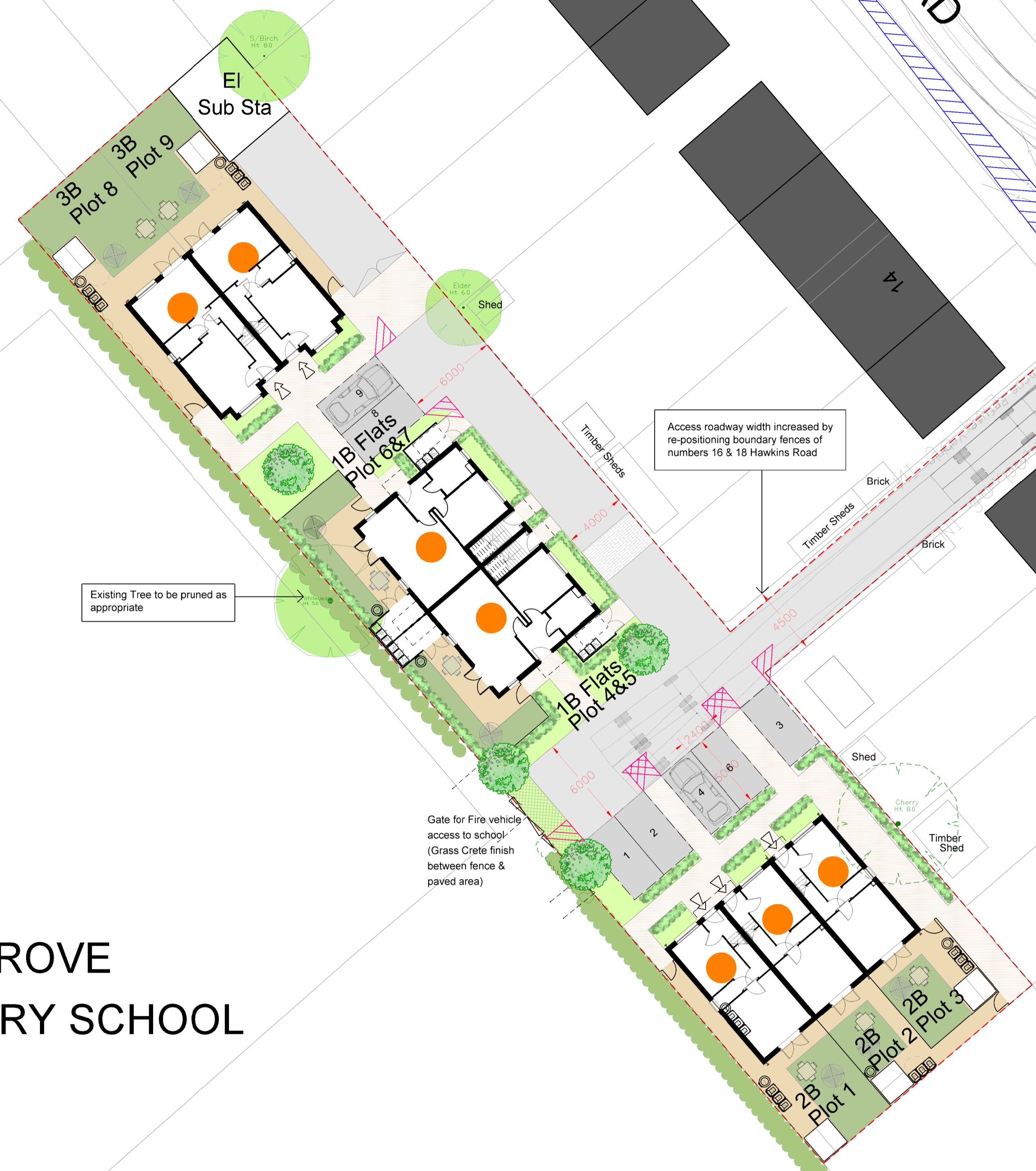
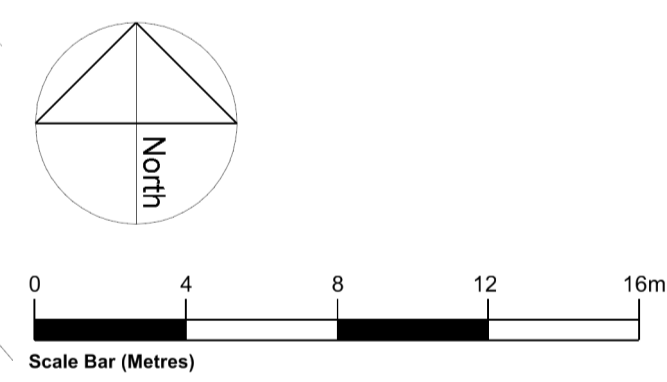

No.	Revision	Date	Chk	Auth
C	General Revisions	06.06.14	LG	NDMG
B	Revisions from pre-planning meeting	16.05.14	VAH	NDMG
A	General Revisions	17.04.14	CR	NDMG

PLANNING

Chartered Architects
119 Newmarket Road
Cambridge
CB5 9BA
Tel: (01223) 367733
E-mail: office@saundersboston.co.uk

Saunders Boston

Client: **Keepmoat**
Job: **Hawkins Road, Cambridge**
Drawing: **Proposed Site Plan**

Scales: 1:200 at A1 1:400 at A3 Date: 03.06.14
Checked: LG Authorised: NDMG
Number: **1338_P_L_02** Revision: **C**